

6-24-21

UTPB STEM Academy Summer Landscaping Project

The University of Texas Permian Basin STEM Academy in seeking cost quotes for a Summer Landscape Project. The Project is divided into 7 area options; each option shall be priced separate; the STEM Academy may choose to accept one, all or none of the options.

On this bid sheet you will find the area options listed and a blank beside each option, please fill in your cost for the option. Interested contractors are encouraged to visit the site before proposing on this project.

Area 1.

Option 1. _____

Option 2. _____

Option 3. _____

Area 2. _____

Area 3. _____

Area 4. _____

Area 5. _____

Area 6. _____

Area 7. _____

Name of Firm _____

Signature _____ Date _____

By signing this form, you acknowledge that you have reviewed and understand the drawings and have been given the opportunity to visit the site before proposing on this project.

STEM ACADEMY SUMMER LANDSCAPE PROJECT 2021

All work is to be done by a qualified Landscaping Contractor, that has been in business for at least 5 years. Any questionable work shall be removed and replaced at no additional expense to the Owner. The contractor shall take caution while working on campus so not to damage any of the Owners property.

The campus has natural fall to the South and East, the contractor shall ensure proper drainage away from the Buildings and to the South and East as needed to drain the landscape. The Bermuda Grass is not considered established until full coverage has been achieved, there shall be no bare areas over 1'X1'.

The contractor shall provide temporary watering means until the landscaping is established, (+ / - 60) days from hydro seeding) and accepted by the Owner.

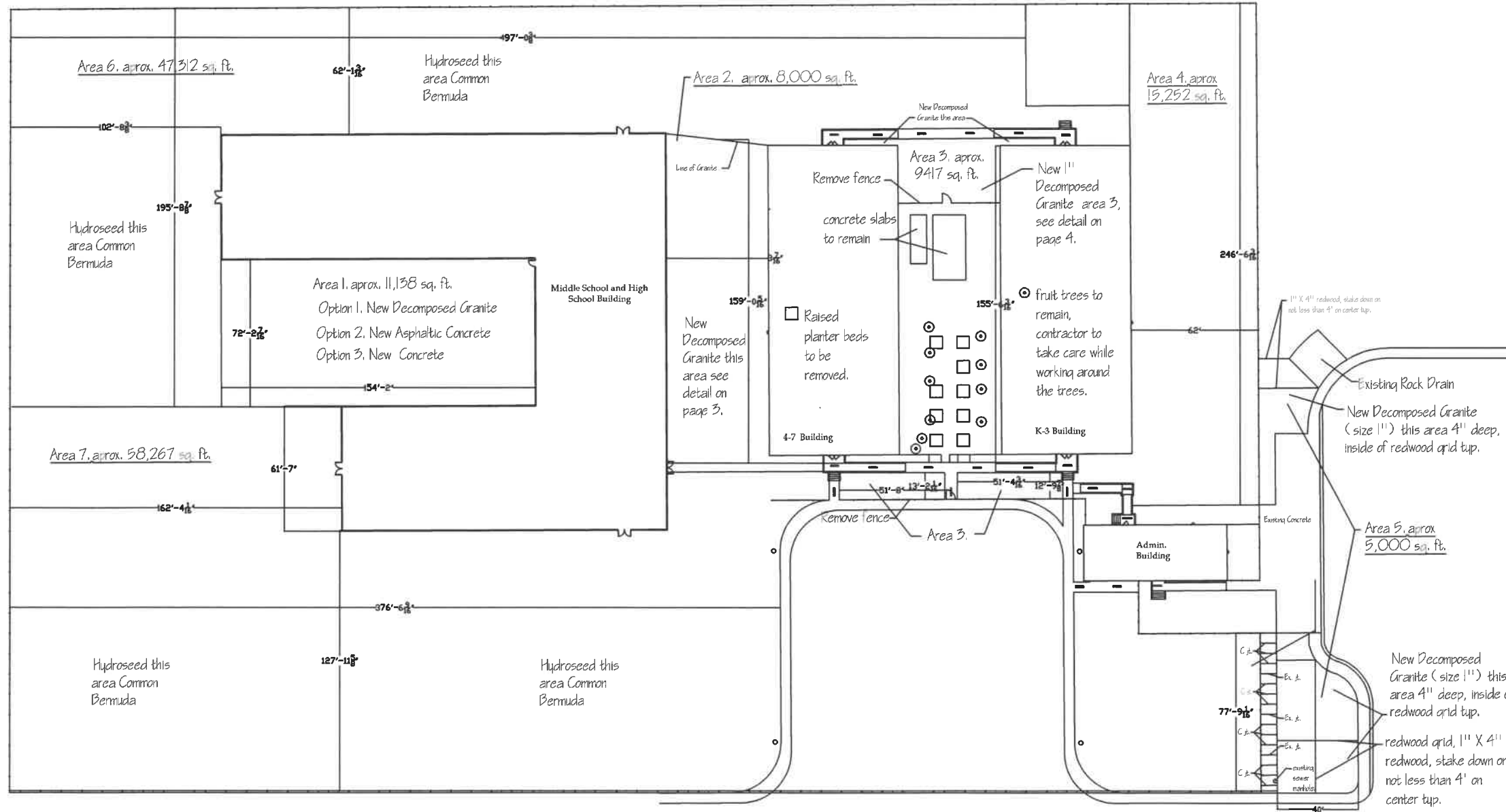

Area 1, located in the "U" shape area of the Middle School Building, this area we are asking for 3 options.

- Option 1, 4" of Decomposed Granite.
- Option 2, 1 1/2" Asphalt paving on prepared sub base.
- Option 3, 4" of 3,000 PSI concrete.

Area 2, approx. 8,000 sq. ft. Area 2, is located between the Middle School Building and the East Elementary Building. This area contains a few plants that the Owner may choose to leave in place.

Area 3, approx. 9417 sq. ft. Area 3, is located between the two Elementary Buildings. This area is the Garden Area, the contractor shall take extra care to save all of the fruit trees, box out a 4'X4' area at each tree. The contractor shall remove and haul from the site all raised planter beds. The contractor shall remove the chain link fencing as indicated. There are 2 small concrete slabs with steel frame work for shade structures to remain in place. The contractor shall grade existing soils to maintain proper drainage to the South end of the area, before placing the decomposed granite.

Area 4, approx. 15,252 sq. ft. Area 4, is located between the K-3 Building and the fence to the West, rake and remove all rocks 1" and larger, Hydroseed common Bermuda grass.

Area 5, approx. 15,252 sq. ft. Area 5, is located between on the West end of the campus near the parking lot, 2 small areas. Add 6' wide by 80' long sidewalk, with toded control joints 5' O/C, expansion joints 20' O/C.

Area 6, approx. 47,312 sq. ft. Area 6, Blade off area, ensure drainage to the South and East, Hydroseed Common Bermuda.

Area 7, approx. 58,267 sq. ft. Area 7, Blade off area to ensure the area is flat, and ensure drainage to the East, Hydroseed Common Bermuda.

STEM ACADEMY SUMMER LANDSCAPE PROJECT 2021

All work is to be done by a qualified Landscaping Contractor, that has been in business for at least 5 years. Any questionable work shall be removed and replaced at no additional expense to the Owner. The contractor shall take caution while working on campus so not to damage any of the Owners property.

The campus has natural fall to the South and East, the contractor shall ensure proper drainage away from the Buildings and to the South and East as needed to drain the landscape. The Bermuda Grass is not considered established until full coverage has been achieved, there shall be no bare areas over 1'X1'. The contractor shall provide temporary watering means until the landscaping is established, (+ / - 60) days from hydro seeding) and accepted by the Owner.

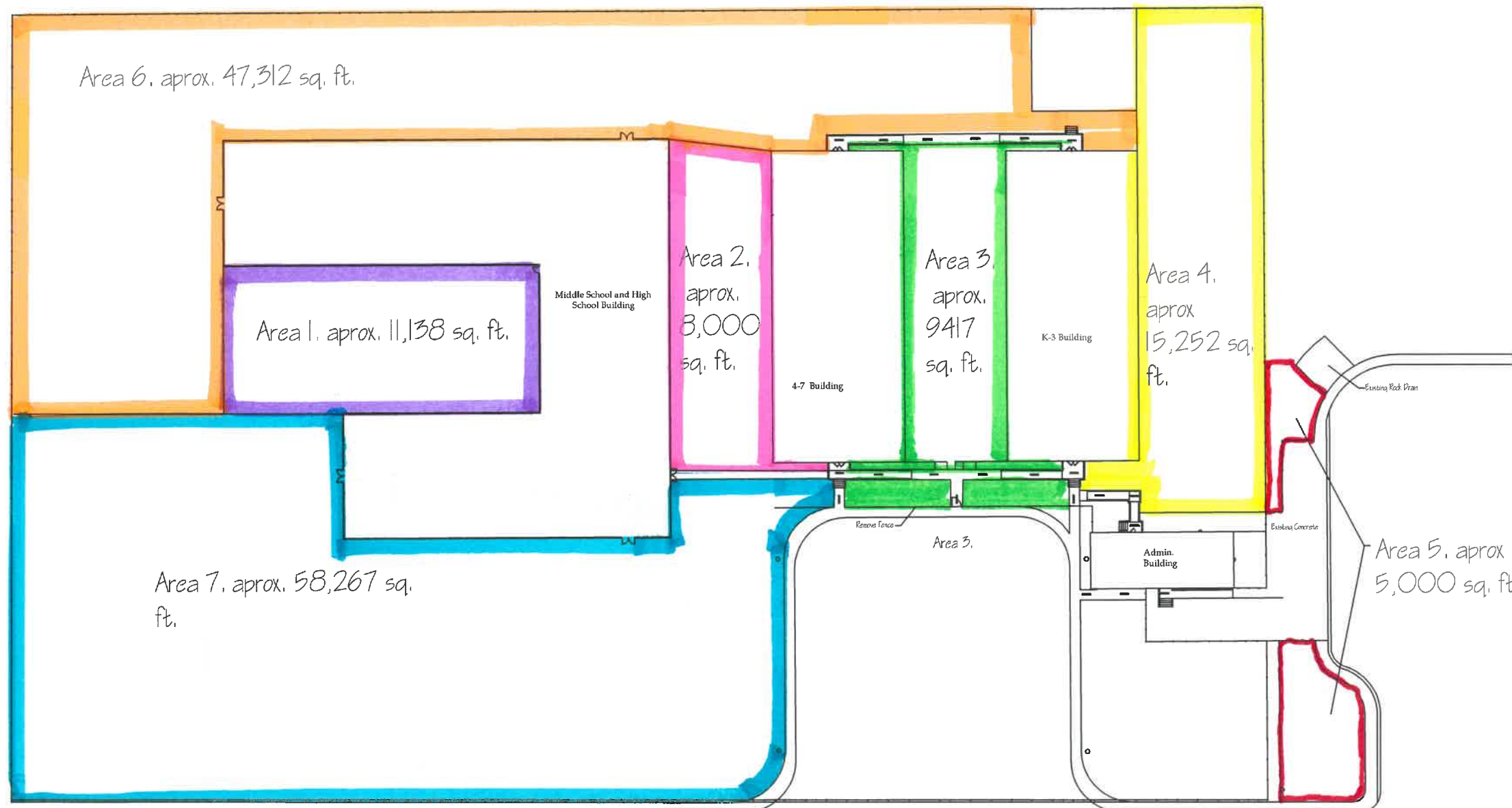

Area 1, aprox. 11,138 sq. ft.
Area 1, located in the "U" shape area of the Middle School Building, this area we are asking for 3 options.
Option 1, 4" of Decomposed Granite.
Option 2, 1 1/2" Asphalt paving on prepared sub base.
Option 3, 4" of 3,000 PSI concrete.

Area 2, aprox. 8,000 sq. ft.
Area 2, is located between the Middle School Building and the East Elementary Building, This area contains a few plants that the Owner may choose to leave in place.

Area 3, aprox. 9417 sq. ft.
Area 3, is located between the two Elementary Buildings. This area is the Garden Area, the contractor shall take extra care to save all of the fruit trees, box out a 4'X4' area at each tree. The contractor shall remove and haul from the site all raised planter beds. The contractor shall remove the chain link fencing as indicated. There are 2 small concrete slabs with steel frame work for shade structures to remain in place. The contractor shall grade existing soils to maintain proper drainage to the South end of the area, before placing the decomposed granite.

Area 4, aprox. 15,252 sq. ft.
Area 4, is located between the K-3 Building and the fence to the West, rake and remove all rocks 1" and larger, Hydroseed common Bermuda grass.

Area 5, aprox. 15,252 sq. ft.
Area 5, is located between on the West end of the campus near the parking lot, 2 small areas. Add 6' wide by 80' long sidewalk, with toolled control joints 5' O/C, expansion joints 20' O/C.

Area 6, aprox. 47,312 sq. ft.
Area 6, Blade off area, ensure drainage to the South and East, Hydroseed Common Bermuda.

Area 7, aprox. 58,267 sq. ft.
Area 7, Blade off area to ensure the area is flat, and ensure drainage to the East, Hydroseed Common Bermuda.

Middle School Building

4-7 Building

Area 2.

aprox. 8,000 sq. ft.

20'

20'

concrete slabs to remain

concrete slabs to remain

New Decomposed Granite (size 1") this area 4" deep, inside of redwood grid tnp.

20' X 20' redwood grid, 1" X 4" redwood, stake down on not less than 4' on center tnp.

1" X 4" redwood frame around trees tnp.

Place mulch inside of 4' X 4' frame around trees.

51'-8" 13'-2 1/16"

Remove fence

Line of Granite

UTPB STEM Academy Summer Landscaping Project 2021

June 23, 2021

Jhaney 432-552-2760

Page 3

New Decomposed
Granite this area

4-7 Building

K-3 Building

Area 3,

aprox. 9,417 sq. ft.

concrete
slabs to
remain

New Decomposed
Granite (size 1") this
area 4" deep, inside
of redwood grid twp.

20' X 20' redwood grid, 1" X 4"
redwood, stake down on not less
than 4" on center twp.

1" X 4" redwood frame around
trees twp.

Place mulch inside of 4' X 4' frame
around trees.

20'
20'

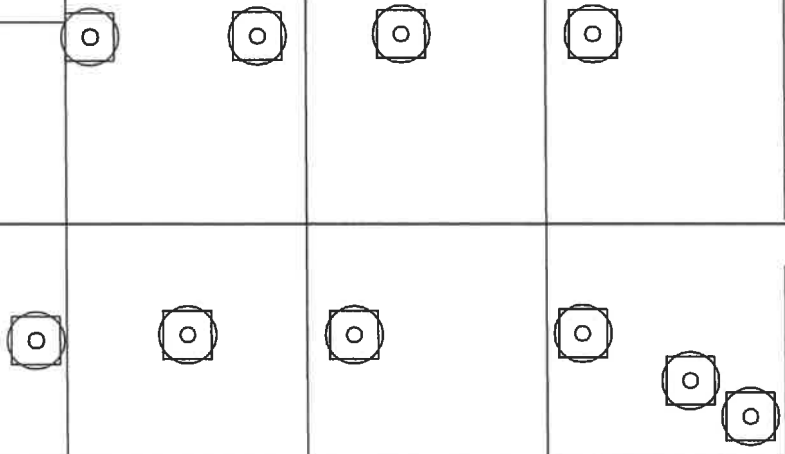

51'-4 ³/₁₆" 12'-9 ⁷/₈"

51'-8" 13'-2 ¹/₁₆"

Remove fence

Area 3.

UTPB STEM Academy Summer Landscaping Project 2021